

Location portfolio

# Frankfurt Wiesen- hüttenplatz

**DESIGN OFFICES**

# GROUND Floor

Meeting & Conference Spaces

 With flexible walls

- 1 Training Room I
- 2 Training Room II
- 3 Training Room III
- 4 Training Room IV
- 5 Training Room I + II
- 6 Training Room II + III
- 7 Training Room III + IV
- 8 Training Room I + II (XL)
- 9 Training Room I – III (XL)
- 10 Training Room I - III
- 11 Training Room II - IV
- 12 Training Room I – IV
- 13 Arena
- 14 Arena (XL)
- 15 DO.Café
- 16 DO.Lounge

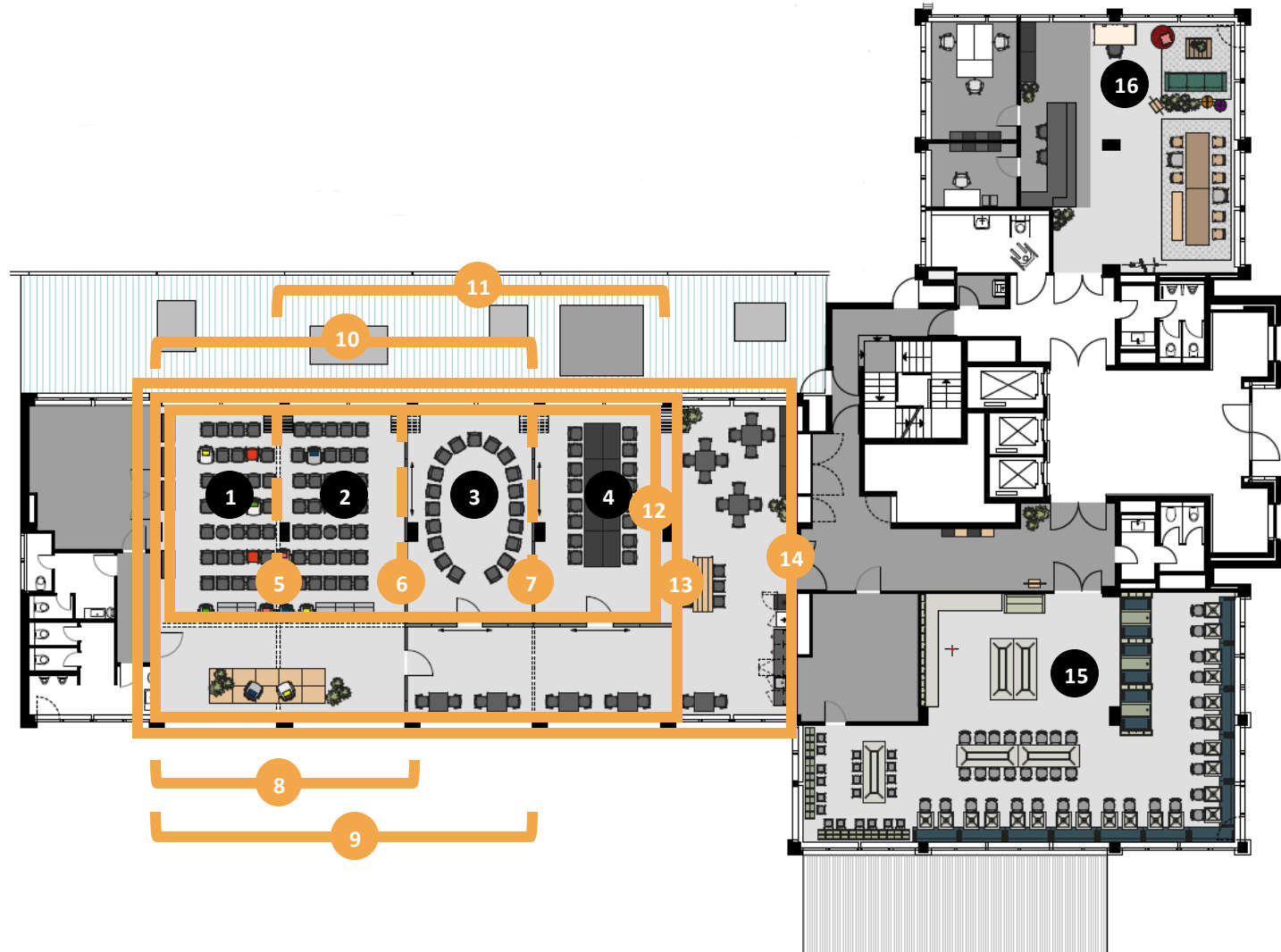





# 6<sup>th</sup> Floor

Meeting & conference spaces

 With flexible walls

- 1 Meet & Move Room S
- 2 2 x Meet & Move Room S
- 3 Meet & Move Room M
- 4 Meet & Move Room S + M
- 5 Meet & Move Room L
- 6 2 x Meet & Move Room M
- 7 Arena II
- 8 Co-Working Space
- 9 Work Lab
- 10 Rooftop Terrace
- 11 Rooftop Lounge
- 12 Rooftop Lounge + Terrace

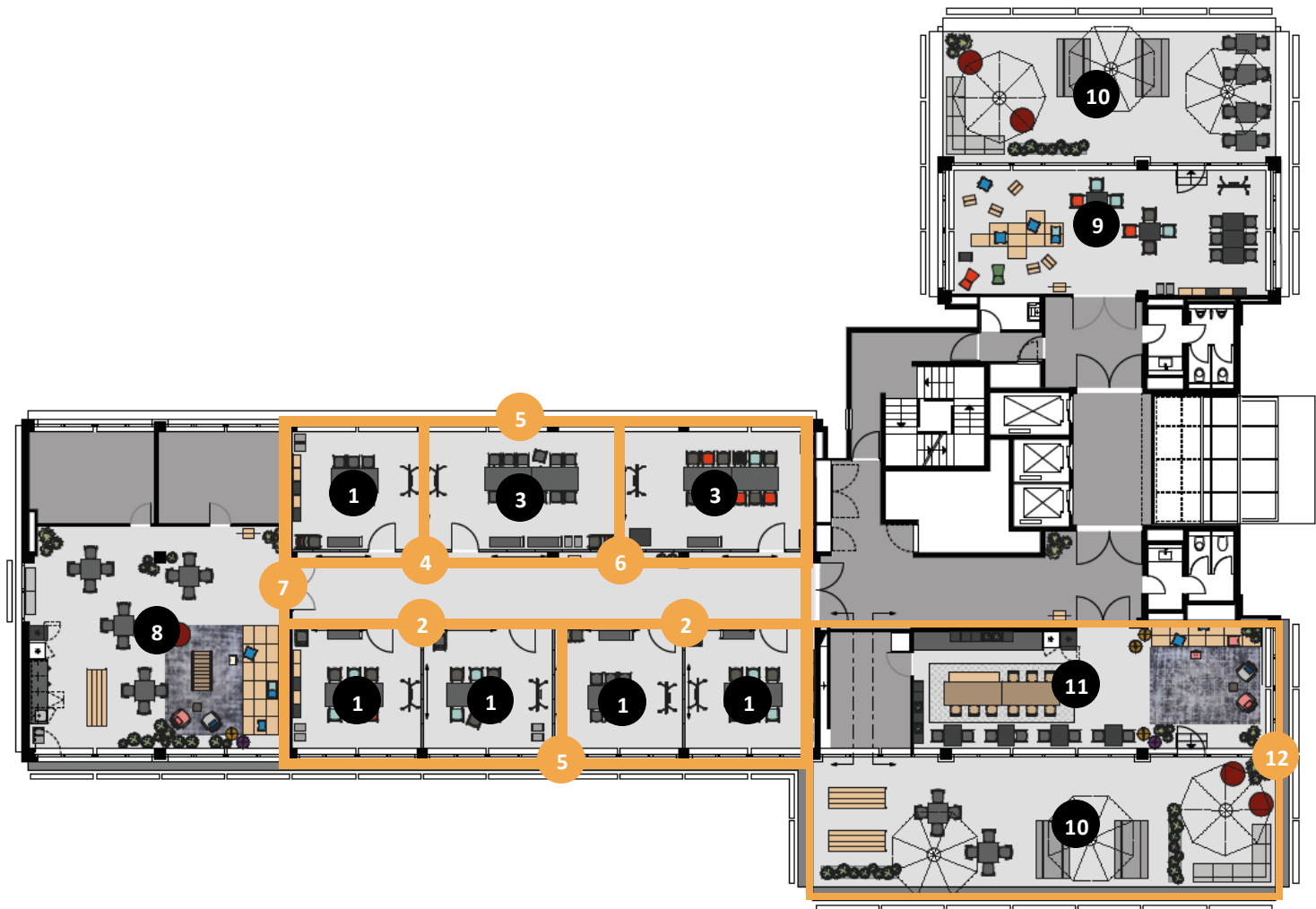

# 6<sup>th</sup> Floor

Seating Plan



|    |                          | m <sup>2</sup> | L x W x H<br>in metres | New Work                                  | U-shaped | Parliamentary | Theatre | Block | Circle | Banquet |
|----|--------------------------|----------------|------------------------|---|----------|---------------|---------|-------|--------|---------|
| 1  | Meet & Move Room S       | 23             | 4.6 x 4.9 x 3.6        |   |          |               |         | 8     |        |         |
| 2  | 2 x Meet & Move Room S   | 46             | 4.6 x 10.0 x 3.6       |   |          |               |         | 20    |        |         |
| 3  | Meet & Move Room M       | 33             | 4.6 x 7.4 x 3.6        |   |          |               |         | 12    |        |         |
| 4  | Meet & Move Room S + M   | 55             | 4.6 x 12.0 x 3.6       |   |          |               |         | 28    |        |         |
| 5  | Meet & Move Room L       | 92             | 4.6 x 19.9 x 3.6       |   |          |               |         | 40    |        |         |
| 6  | 2 x Meet & Move Room M   | 66             | 4.6 x 14.4 x 3.6       |   |          |               |         | 28    |        |         |
| 7  | Arena II                 | 241            | 12.1 x 19.9 x 3.6      |   |          | 96            | 198     |       |        |         |
| 8  | Co-Working Space         | 85             | 8.5 x 10.0 x 3.6       | Lounge furniture for 20 people            |          |               |         |       |        |         |
| 9  | Work Lab                 | 62             | 12.0 x 5.0 x 3.6       | 40  | 20       | 20            | 40      | 20    | 20     |         |
| 10 | Rooftop Terrace          | 64             | 5.0 x 12.7 x 3.6       | Lounge and bistro furniture               |          |               |         |       |        |         |
| 11 | Rooftop Lounge           | 65             | 4.6 x 13.9 x 3.6       | Lounge and bistro furniture for 90 people |          |               |         |       |        |         |
| 12 | Rooftop Lounge + Terrace | 88             | 5.0 x 17.7 x 3.6       | Lounge and bistro furniture               |          |               |         |       |        |         |